



CENTRAL TEXAS REGIONAL  
MOBILITY AUTHORITY



# MOPAC EXPRESS LANE FACT SHEET

## MOPAC EXPRESS LANE ENTRANCE AND EXIT MAP

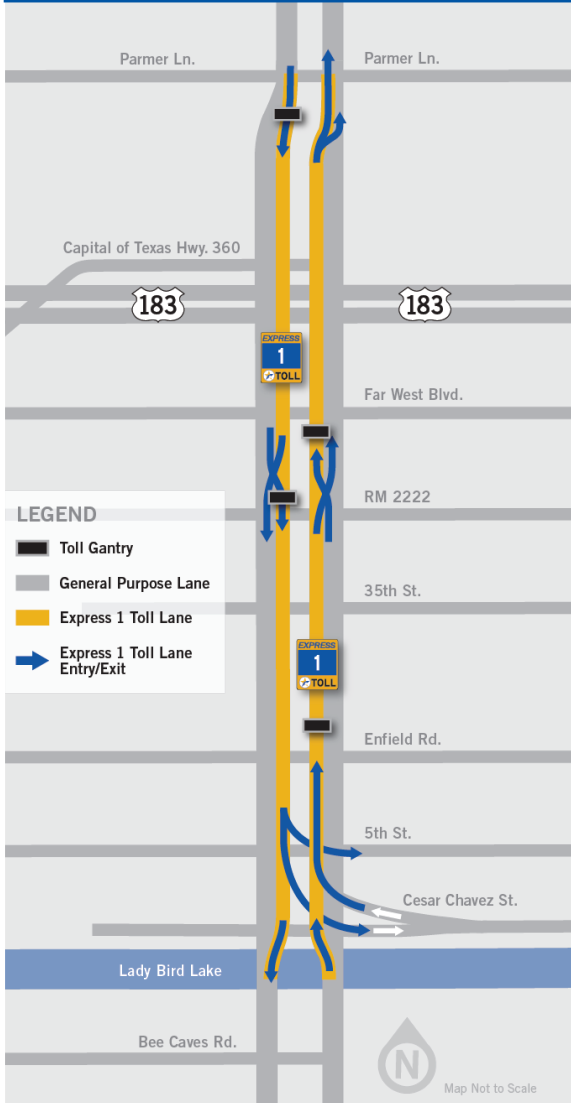

### EXPRESS LANE ENTRANCE AND EXIT LOCATIONS

**NORTH:** near Parmer Lane

**CENTRAL:** between Far West Boulevard  
and RM 2222

**SOUTH:** near Cesar Chavez Street and  
5th Street

## OVERVIEW

The MoPac Express Lane offers drivers the option to bypass congestion on the 11-mile stretch of MoPac between Parmer Lane and Cesar Chavez Street. Those who prefer not to pay a toll can still use the non-tolled lanes on MoPac.

## PROJECT DESCRIPTION

The MoPac Express Lane is a special buffer-separated lane that uses variable tolls to keep traffic moving even when the adjacent lanes are congested. This is accomplished by raising the toll when traffic is heavy and lowering the toll when traffic is light, leveraging supply and demand principles to ensure drivers have a reliable, congestion-free route to their destination. The Express Lane is located in the middle of the MoPac corridor, separated from the existing general purpose lanes by a striped buffer zone and flexible plastic delineator sticks.

## VARIABLE TOLL PRICING

To manage the number of cars in the Express Lane at any given time, variable toll pricing is used. When traffic is heavy and demand is high, toll rates increase. When demand is low, toll rates decrease. Higher rates manage congestion by discouraging drivers to enter the lanes and ensure a reliable trip for drivers when they need it. Public transit buses, registered van pools and first responders ride toll-free in the Express Lane.

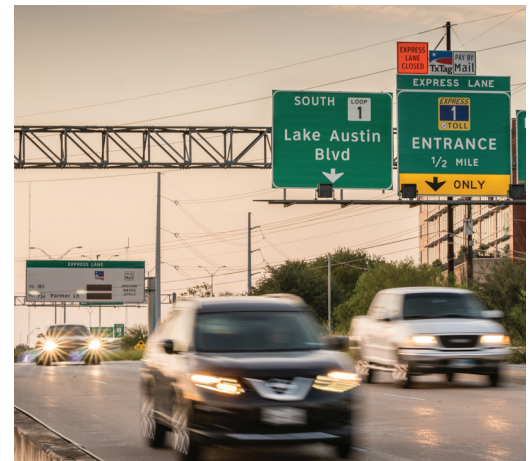



CENTRAL TEXAS REGIONAL  
MOBILITY AUTHORITY



# MOPAC EXPRESS LANE FACT SHEET

## EXPRESS LANE PERFORMANCE

With average speeds **above 50 miles per hour**, the Express Lane allows drivers **up to a 50 percent faster commute**.



The MoPac Express Lane carries up to 1,600 vehicles per hour, **freeing up capacity** in the non-tolled lanes.

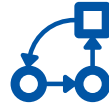

An algorithm and operators **adjust toll rates** to keep traffic moving.



Toll-free access for Capital Metro has **increased** Express Bus **ridership** by 73 percent\* on MoPac.

*\*Between October 2017 and October 2018*



Real-time traffic monitoring through the Traffic & Incident Management (TIM) Center facilitates **swift incident clearance** and emergency response.

## MANAGEMENT

Our TIM Center houses state-of-the-art technology to monitor traffic flow, and serves as the heart of MoPac operations. The data fed into the TIM Center through high detection cameras and vehicle-detection sensors enables faster emergency response, coordination of resources for incident or debris clearance, and enhances safety for all travelers.

## PAYMENT OPTIONS



### ELECTRONIC TAG

Customers can pay their tolls with a TxTag, TollTag, EZ TAG, KTAG, Pike-pass or BancPass and get a 33% discount.

*\* TxTag is operated by TxDOT and is available online at [www.TxTag.org](http://www.TxTag.org), or by calling 1-888-GO-TxTag.*



### PAY BY MAIL

If you don't have a tag just keep moving, and we'll bill you through the Pay By Mail program. Pay By Mail customers are billed using a picture of their license plate, and are charged a \$1.00 statement fee per bill.

*\* Pay by Mail is available online at [www.PayMobilityBill.com](http://www.PayMobilityBill.com), or by calling 1-833-762-8655.*

### PAY IN PERSON

Customers can visit our service center or one of many participating stores to pay in person. Visit [www.PayMobilityBill.com/pay-in-person](http://www.PayMobilityBill.com/pay-in-person) to see your options.



## DID YOU KNOW?

The most common make of vehicles in the Express Lane are those driven by middle income residents.

**Ford makes up 15.2 percent** of vehicles, followed by **Toyota at 12.7 percent**, and **Chevrolet at 10.7 percent**.